



- 35 mm DIN rail mounting, EN 50022
- High switching capacity
- High inrush current
- Test button

Contacts

Contact number & arrangement		2NO
Contact material		AgCdO
Max. switching voltage	AC/DC	400 V / 400 V
Min. switching voltage		10 V
Rated load	AC1	25 A / 380 V AC
	AC3	15 A / 380 V AC
Min. switching current		10 mA
Max. inrush current		40 A
Rated current		25 A
Max. breaking capacity	AC1	9 500 VA
	AC3	5 700 VA
Min. breaking capacity		1 W
Resistance		≤ 100 mΩ
Max. operating frequency		
• at rated load	AC1	600 cycles/hour
	AC3	600 cycles/hour
• no load		3 600 cycles/hour

Coil

Rated voltage	50 Hz AC	12-24-110-230-380 V
	DC	12-24-48-110-220 V
Must release voltage		≥ 0,1 U _n
Operating range of supply voltage		see Table 1, 2
Rated power consumption	AC	3,0 VA
	DC	1,5 W

Insulation

Insulation category		C400
Insulation rated voltage		400 V AC
Dielectric strength		
• coil - contact		5 000 V AC
• contact - contact		1 500 V AC
• pole - pole		5 000 V AC
Contact - coil distance		
• clearance		≥ 6 mm
• creepage		≥ 8 mm

General data

Operating time (typical value)		20 ms
Release time (typical value)		20 ms
Electrical life		
• resistive AC1		≥ 10 ⁵ 25 A, 380 V AC
• cos φ		see Fig. 2
Mechanical life (cycles)		≥ 10 ⁶
Dimensions (L x W x H)		26 x 49 x 72 mm
Weight		130 g
Ambient temperature		
• storing		-25...+85 °C
• operating		-25...+85 °C
Cover protection category		IP 20
Shock resistance		10 g
Vibration resistance		5 g 10...150 Hz

Standard contact material marked with bolt type.



Coil data - DC voltage version

Table 1

Coil code	Rated voltage V DC	Coil resistance ±10% at 20 °C Ω	Coil operating range V DC	
			min. (at 20°C)	max. (at 55°C)
1012	12	85	9,6	13,2
1024	24	340	19,2	26,4
1048	48	1 350	38,4	52,8
1110	110	7 600	88,0	121,0
1220	220	30 000	176,0	242,0

Standard coil rated voltages marked with bold type.

Coil data - AC 50 Hz voltage version

Table 2

Coil code	Rated voltage V AC	Coil resistance ±10% at 20 °C Ω	Coil operating range V AC	
			min. (at 20°C)	max. (at 55°C)
3012	12	17	8,4	13,2
3024	24	76	16,8	26,4
3110	110	1 600	77,0	121,0
3230	230	6 800	161,0	253,0
3380	380	17 700	266,0	418,0

Standard coil rated voltages marked with bold type.

Dimensions

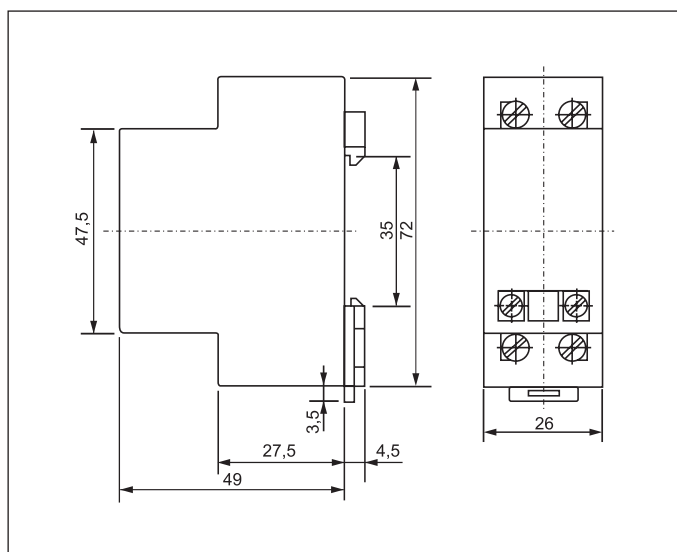

Connections diagram (pin side view)

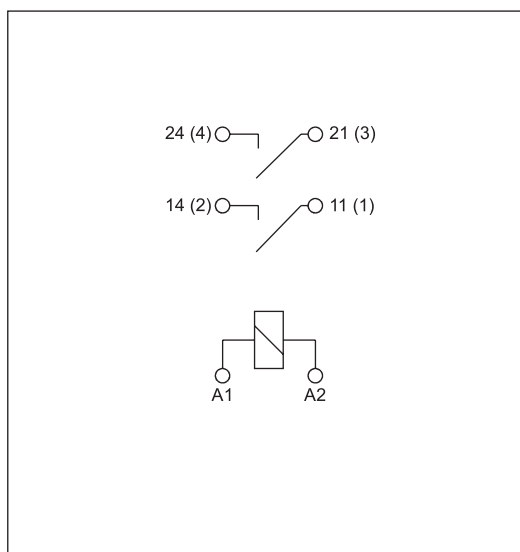

Electrical life at AC resistive load Fig. 1

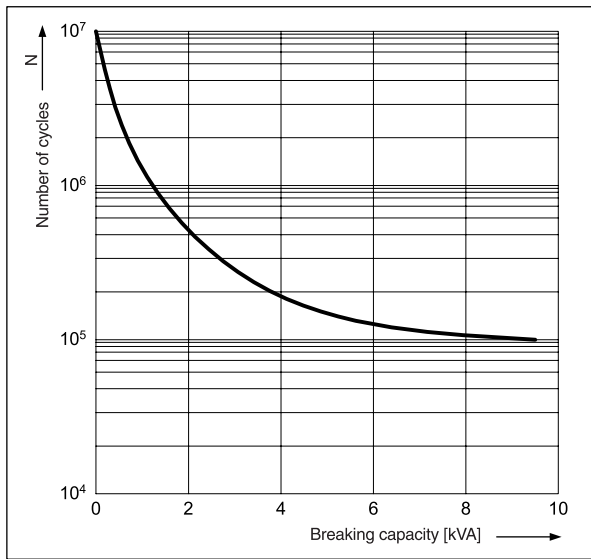

Electrical life reduction factor at AC inductive load Fig. 2

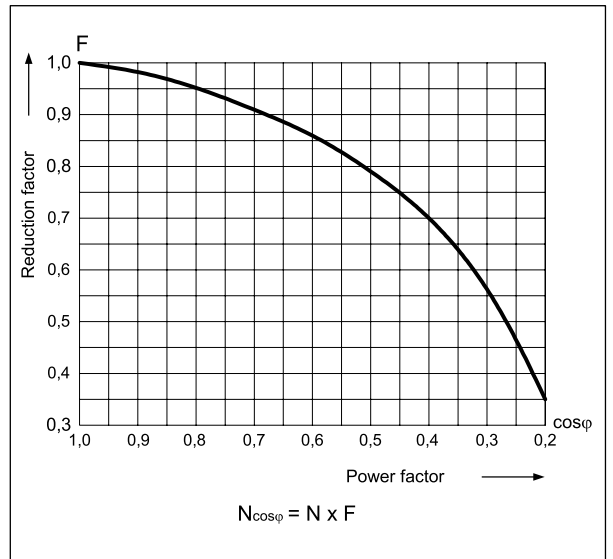

Mounting

Relays **RG25** are designed for 35 mm DIN rail mounting, EN 50022. Operational position - contacts downwards.

Ordering codes

