

**DIMENSIONS**

All dimensions in mm [inches]

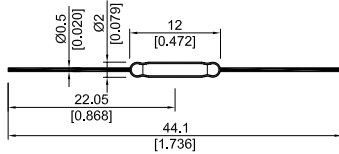

**CHARACTERISTICS**

- Glass length of 12 mm and diameter of 2.0 mm
- Normally open 1 Form A contact
- Excellent for low level applications

**CONTACT DATA**

All data at 20 °C	Switch Model → Contact Form →	KSK-1A46-... Form A			Units
		Min.	Typ.	Max.	
<b>Contact Ratings</b>	<b>Conditions</b>				
Contact Rating *	Any DC combination of V & A not to exceed their individual max.'s			10	W
Switching Voltage	DC or peak AC			200	V
Switching Current	DC or peak AC			0.5	A
Carry Current	DC or peak AC			1.0	A
Static Contact Resistance	w/ 0.5V & 10mA			150	mΩ
Dynamic Contact Resistance	Measured w/ 0.5V & 50mA 1.5 ms after closure			200	mΩ
Insulation Resistance across Contacts	100 Volts applied	10 <sup>12</sup>			Ω
Breakdown Voltage	Voltage applied for 60 sec. min.	225			VDC
Operate Time, Incl. Bounce	Measured w/ 100% overdrive			0.7	ms
Release Time	Measured w/ no coil suppression			0.1	ms
Capacitance	@ 10kHz across contact		0.2		pF
Test Coil **		KMS-01			
Standard AT range		10		40	AT
<b>Environmental Data</b>					
Shock Resistance	1/2 sine wave duration 11ms			50	g
Vibration Resistance	From 10 - 2000 Hz			20	g
Ambient Temperature	10 °C/ minute max. allowable	-20		130	°C
Storage Temperature	10 °C/ minute max. allowable	-55		130	°C
Soldering Temperature	5 sec. dwell			260	°C
Please note: The indicated electrical data are maximum values and can vary downwards when using a more sensitive switch.					
* For life expectancy see our life test section located on page 151.					
** See our test coil section located on page 157.					

**ORDER INFORMATION**

SERIES	CONTACT FORM	SWITCH MODEL	AT RANGE (between)
<b>KSK -</b>	<b>1A</b>	<b>46 -</b>	<b>XXXX</b>
<b>OPTIONS</b>			<b>10 40</b>

**Part Number Example - KSK - 1A46 - 1015**

**1015** is the AT range (Any AT can be ordered between 10 & 40 in a minimum range of 2 AT)